

## METAL ROOF RESIDENTIAL GUIDE

Gathering all the information for a Metal Roof quote can be intimidating if you don't understand the technical terms. This guide will simplify the process so you can feel confident when a customer is inquiring about metal roofing. A general list that we need to be able to quote a project for you is.

- 1.What Style of Roof Panel?
- 2.What Gauge?
- 3.What Color?

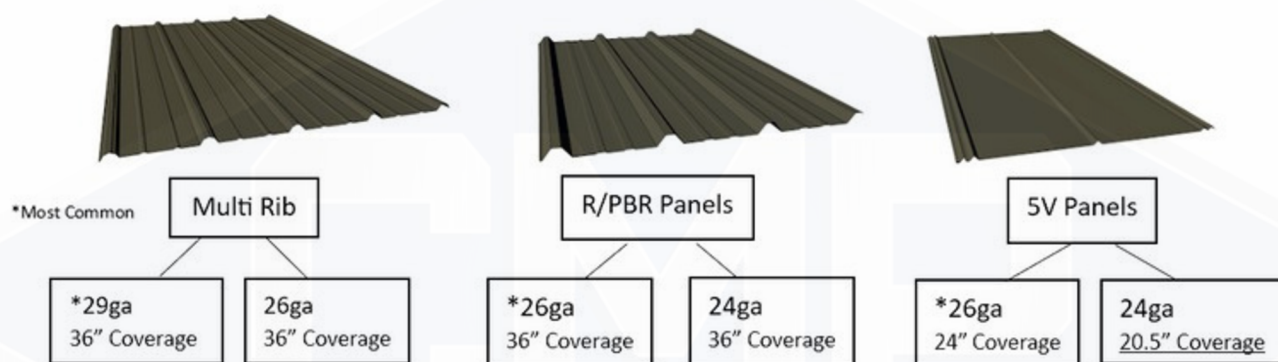

If a customer has a full eagle view, roof panels, and gauge you may email us, and we can get that quoted for you.

### ROOF TYPES

Once the customer has picked the panel, color, and gauge. We can figure out the number of panels needed. All roofs are different, here are some different types.

**Gable**

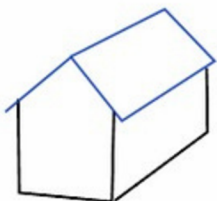

**Hip**



**Gambrel**

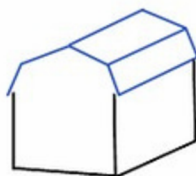

**Shed "Lean to"**

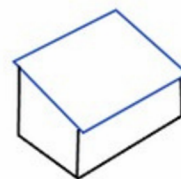

Now we will work on gathering the information for...

- Panel List
- Trim List
- Roof Pitch

\*Ask for any accessories needed\*

How to determine how many panels are needed for your customer. There are different styles of roofs. Let's say it's a Gable style which is most common. If we have the Length and Width, we can calculate the number of panels needed.

## GABLE STYLE ROOF

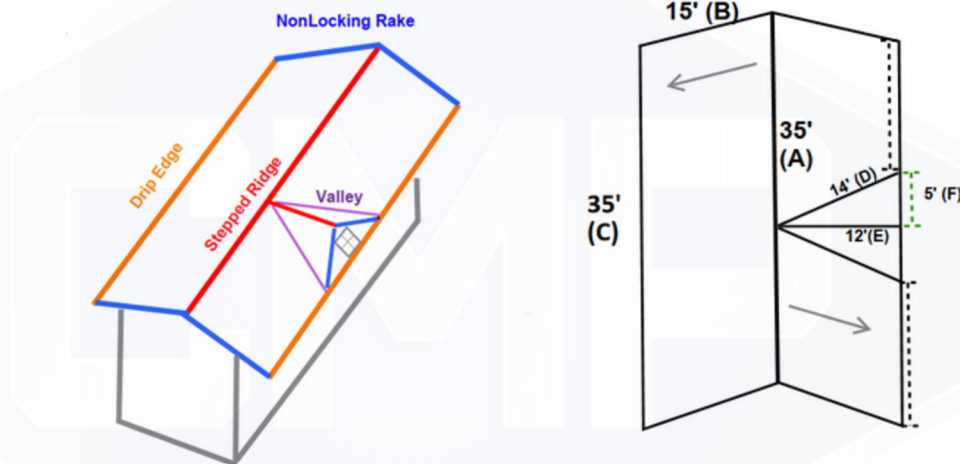

### MAIN ROOF

$A \div \text{Panel Coverage} = \text{Number of panels}$

$35' \div 3' = 11.66$  round-up 12 panels (Feet)

$420'' \div 36'' = 11.66$  round-up 12 panels (Inches)

Since we have two sides, they will need 24 panels.

We suggest adding 2" of overhang.

### PANEL LIST

24 @ 15' 2"

10 @ 5'

### ROOF DORMER

$E \div \text{Panel Coverage} = \text{Number of panels}$

$12' \div 3' = 4 \times 2$  (Sides) = 8 + 2 (adding 2 for small front dormer section) ↓ = 10 panels

Since they will have to cut panels around the dormer, we add 2 more to ensure they have enough.

**TRIM** For the trim, we have a simple example highlighted. We sell trim in 10' sections. We can make them longer, adding a 20% upcharge per LF. We do bend custom trim, just send us a sketch with specific measurements. You will take the linear footage and divide it by 9.5' Note that the trim needs to overlap 6 inches.

- **Stepped Ridge:**  $35' \div 9.5 = 3.68$  Round up to 4
- **Drip Edge:**  $35' \times 2 = 70' \div 9.5 = 7.36$  Round up to 8
- **Non-Locking Box Rake:**  $15' \times 4 = 60' \div 9.5 = 6.31$  Round up to 7
- **Valley:**  $14' \times 2 = 28' \div 9.5 = 2.9$  Round up to 3

## Trim List

- **Stepped Ridge 4 @ 10'**
- **Drip Edge 8 @ 10'**
- **Non-Locking Box Rake 7 @ 10'**
- **Valley 3 @ 10'**

## HIP STYLE ROOF

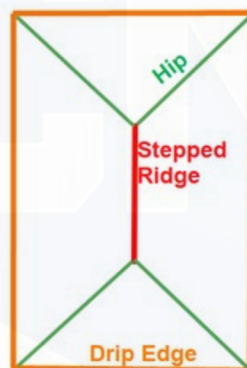

Front

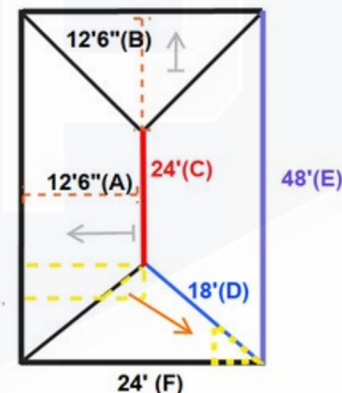

Front

Hip style is different because of the triangular shape on two ends. As you cut panels to fit one side they will fit on another angle. Let's begin figuring out the panel list. Based on 4:12 pitch.

$E \div \text{Panel Coverage} = \text{Panels for the long side}$

$$48' \div 3' = 16 \times 2(\text{long sides}) + 4 (\text{panels for the short sides}) = 36$$

## PANEL LIST

36 @ 12'8"

\*Ordering in full panel lengths is most common for hip roofs.

## TRIM

For the trim, we have a simple example highlighted. We sell trim in 10' sections. We can make them longer, adding a 20% upcharge per LF. We do bend custom trim, just send us a sketch with specific measurements. You will take the linear footage and divide it by 9.5' to determine the number of pieces. 9.5' takes into account your trim lap and folding the ends.

- **Stepped Ridge:**  $24' \div 9.5 = 2.52$  Round up to 3
- **Hip:**  $18' \times 4 = 72' \div 9.5 = 7.57$  Round up to 8
- **Drip Edge:**  $24' \times 2 = 48'$  ----  $48' \times 2 = 96'$
- $48' + 96' = 144' \div 9.5 = 15.15$  Round up to 16

## Trim List

- **Stepped Ridge 4 @ 10'**
- **Hip 8 @ 10'**
- **Drip Edge 8 @ 10'**

**ROOF PITCH** Roof pitch or slope tells you how many inches the roof Rises for every 12" in depth. An example of a roof pitch would be 4/12 – The roof rises 4" every 12" inward towards the ridge.

I hope this packet has helped you understand how to gather the information needed for a quote. If you have any questions feel free to send us an email or call our office at 704-871-8704. Our branch also offers a workshop, where we can show sales associates and contractors the basics of installing metal roofing.

## IN THIS PACKAGE, WE HAVE ALSO INCLUDED

COLOR CHARTS	PANEL INFO SHEET	TRIM INFO SHEETS
<ul style="list-style-type: none"> <li>• <a href="https://cmpmetalsystem.wpenginepowered.com/wp-content/uploads/2021/02/Digital-24-Gauge-Color-Chart.pdf">https://cmpmetalsystem.wpenginepowered.com/wp-content/uploads/2021/02/Digital-24-Gauge-Color-Chart.pdf</a></li> </ul>	<ul style="list-style-type: none"> <li>• <a href="https://cmpmetalsystems.com/cmp-product/multi-rib-panel/">https://cmpmetalsystems.com/cmp-product/multi-rib-panel/</a></li> </ul>	<ul style="list-style-type: none"> <li>• <a href="https://cmpmetalsystems.com/wp-content/uploads/2024/06/CMP-R-Panel-PBR-Panel.pdf">https://cmpmetalsystems.com/wp-content/uploads/2024/06/CMP-R-Panel-PBR-Panel.pdf</a></li> </ul>
<ul style="list-style-type: none"> <li>• <a href="https://cmpmetalsystems.com/wp-content/uploads/2024/06/CMP-29-26-GAUGE-COLOR-CHART.pdf">https://cmpmetalsystems.com/wp-content/uploads/2024/06/CMP-29-26-GAUGE-COLOR-CHART.pdf</a></li> </ul>	<ul style="list-style-type: none"> <li>• <a href="https://cmpmetalsystems.com/cmp-product/r-panel-pbr-panel/">https://cmpmetalsystems.com/cmp-product/r-panel-pbr-panel/</a></li> </ul>	<ul style="list-style-type: none"> <li>• <a href="https://cmpmetalsystems.com/wp-content/uploads/2024/06/CMP-R-Panel-PBR-Panel.pdf">https://cmpmetalsystems.com/wp-content/uploads/2024/06/CMP-R-Panel-PBR-Panel.pdf</a></li> </ul>
<ul style="list-style-type: none"> <li>• <a href="https://cmpmetalsystems.com/wp-content/uploads/2024/07/Specialty-Finishes-V2.pdf">https://cmpmetalsystems.com/wp-content/uploads/2024/07/Specialty-Finishes-V2.pdf</a></li> </ul>	<ul style="list-style-type: none"> <li>• <a href="https://cmpmetalsystems.com/cmp-product/5v-panel/">https://cmpmetalsystems.com/cmp-product/5v-panel/</a></li> </ul>	<ul style="list-style-type: none"> <li>• <a href="https://cmpmetalsystems.com/wp-content/uploads/2024/06/5V-trims.pdf">https://cmpmetalsystems.com/wp-content/uploads/2024/06/5V-trims.pdf</a></li> </ul>