

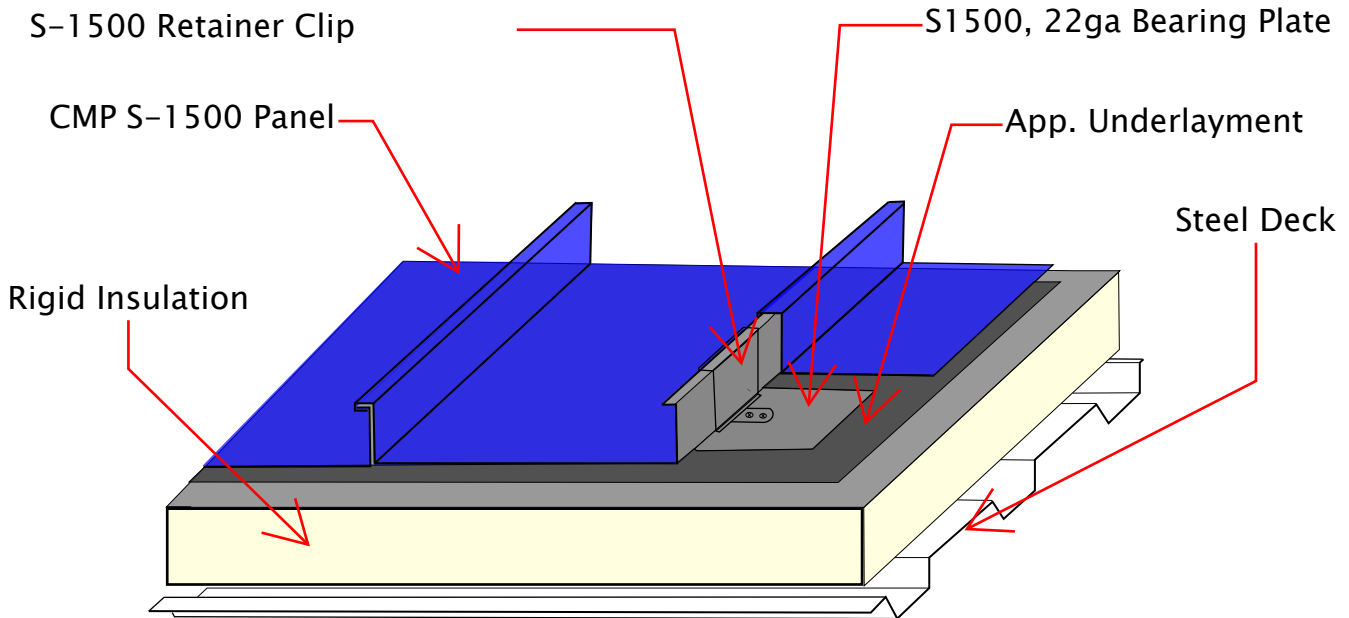

# S-1500 Mechanically Seamed SSMR



## S-1500 Panel Profiles



## S-1500 Panel Types

Pre-Finished Steel	Acrylume	Pre-Finished Aluminum	Copper
22ga (0.79 mm)	22 Ga. (0.79 mm)	0.032" (0.81 mm)	16 oz. (0.56 mm)
24ga. (0.64 mm)	24 Ga. (0.64 mm)	0.040" (1.02 mm)	20 oz. (0.69 mm)

## Warranted System Requirements

System warranties for the S-1500 & S-1500C SSMR are available on a "project to project" basis, only and require CMP's review and approval.

## Footnotes

1. CMP Bearing Plates are required on all insulated systems
2. Full coverage application of approved Ice & Water Barrier required on slopes of 4:12 or less
3. Partial I&W Barrier at all panel terminations (i.e. Eaves, Rakes, Ridges, Valleys, Sidewalls & Penetrations) and 30lb (min.) asphalt felt in the field on slopes greater than 4:12
4. All insulation must be fastened at the rate 5 fasteners/plates per 4'x8' board.
5. Insulation and I&W barrier may be gang attached when immediate panel installation is to take place

# Advantages & Nomenclature

## Stylishly Solid

The Series 1500 is the 2500 system's little brother and is an affordable alternative that cuts cost while maintaining performance. The mechanically crimped side seams can be single locked for most applications, or double locked when taking on blowing rain and snowy environments. These attributes come together making it perfect for light commercial and residential applications.

The Series 1500-"C" is a curved standing seam metal roof panel designed for barrel vault roofs and other arching design elements. The 1500-C can be curved in the factory to radiuses tight as 10' and field curved to a 200' radius. Otherwise this standing seam roof panel is same as the Series 1500 and is available in several steel or aluminum gauges and in a wide variety of colors.

### **Advantages offered with the S-1500 system include:**

- \* Concealed Attachment. The S-1500 system utilizes concealed panel retainer clips allowing for complete installation without exposed fasteners that may backout or fail over time.
- \* Versatile Side Seam Interconnections. The side seams of 1500 panel are profiled to allow for "single" or a "double" lock formation and can take on slopes as low as 3/12.

### **S-1500 Nomenclature:**

Standard Width: 16" Optional Widths: 12" - 18"

Seam Height: 1-1/2" nominal

Min. Panel Length: 24", Max. Panel Length: 64'

Onsite Rollforming: Yes

Pencil Rib Profile: Yes

Striated Profile: Yes

Planks/Mesas: Yes

Embossing: Yes

Tapering: Yes (S-1500)

Curving: Yes (S-1500C)

### **S-1500, S-1500C Warranted System Requirements:**

System warranties for the S-1500 & S-1500C SSMR are available on a "project to project" basis.

**Project review:** Architectural renderings/ project plans must be reviewed to determine warranty availability.